

INSTALLATION INSTRUCTIONS

Laundry Quick Lock Fold Down Clothesline

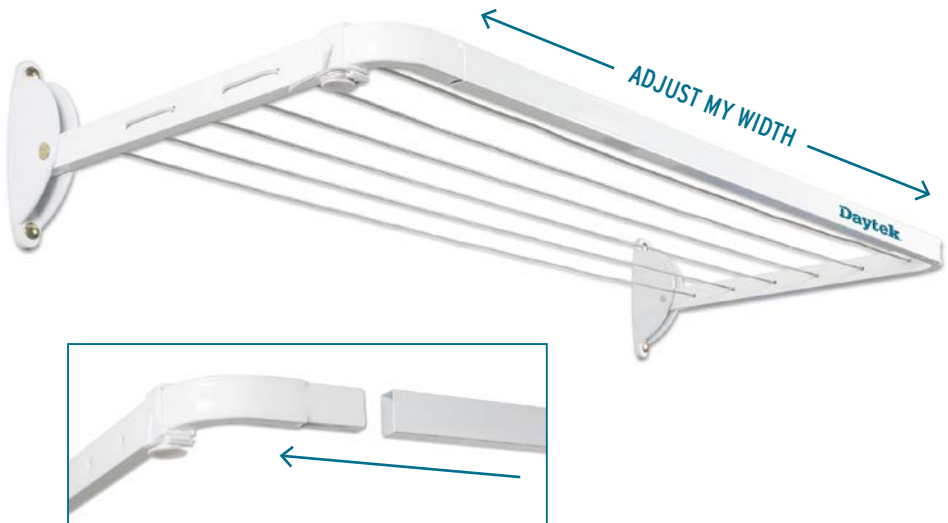

Please check the carton contains all the required parts before assembly.

Your carton should contain the following:

1. **Pre-assembled side-arms** x 2
2. **Front bar** x 1
3. **String** (PVC line cord)
4. **Wall Fixings** x 4 (The fixings included with this clothesline are suitable for masonry or timber only. For fixing to other materials please consult your local hardware store or builder)

WALL MOUNTING INSTALLATION

Materials and Tools required for installation:

- Electronic stud finder (optional)
- Measuring tape & pencil marker
- Drill and drill bit (to suit your particular attachment method)
- Socket set and socket wrench
- Hammer
- Spirit level
- Scissors
- Fixings (if the supplied ones are not suitable to your application)

Location:

Ensure your selected location has sufficient clearance either side of and below the clothesline to safely fold up and down without obstruction.

Consider user height and reach when determining mounting height and position.

Recommended wall area required is 1260mm x 660mm (when folded down).

The width of your clothesline can be adjusted if necessary.

IMPORTANT!

Incorrect installation could damage your wall or cause injury.

Daytek bears no responsibility for improper mounting that results in accident, injury or damage.

Always choose screws or fittings which are suitable for your wall material and have sufficient holding power. Ensure your fixing surface is structurally sound.

If you are unsure of how to mount your Laundry Quick Lock Clothesline, please consult your local hardware specialist or contact Daytek directly.

Figure 1. Laundry Quick Lock Fold Down

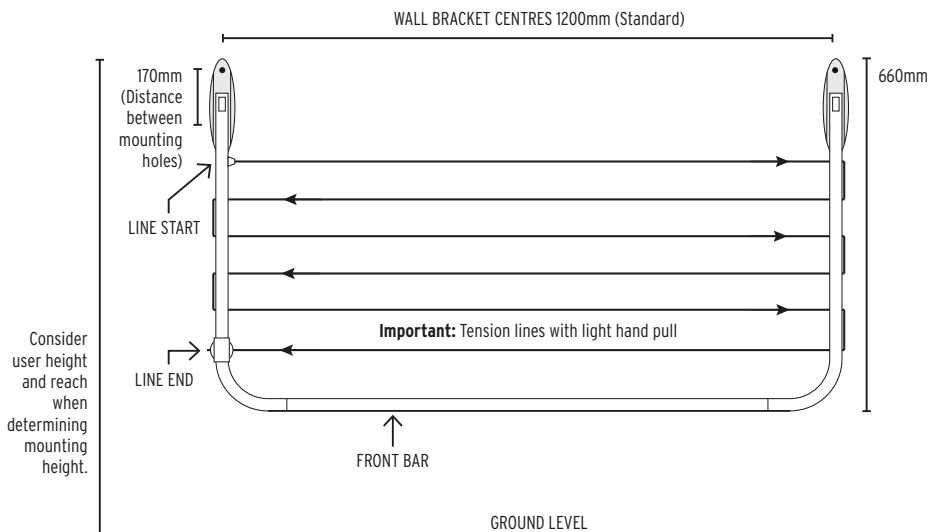

FOLD DOWN INSTALLATION PROCEDURE

OPTIONAL SIZE ADJUSTMENT

You can reduce the width of your clothesline to suit your space needs.

TO REDUCE WIDTH: Determine your required wall bracket centres (distance between fixing points). Deduct the measured distance from the standard length (1200mm). The difference will need to be cut off the FRONT BAR.

Example: If your required width is 900mm then you will need to reduce the overall length of the FRONT BAR by 300mm (1200mm - 900mm = 300mm).

File the end of the tube to remove any sharp edges or burrs. Trial fit the SIDE ARMS to the FRONT BAR to confirm the new mounting width before marking up and securing to the wall.

Note: Warranty will not cover any damage caused to the clothesline as a result of cutting the front bar.

1. Once wall mounting location is decided, mark height position, wall bracket mounting holes and wall bracket centres, ensuring they are level. Our recommended height is user height + 100mm. (See figure 1)

2. **For brick or concrete installations**, drill four mounting holes with 10mm diameter at 50-60mm depth.

For timber wall installations, drill four mounting holes with 5mm diameter at 50mm depth.

For fixing to alternative wall materials, consult your local hardware specialist.

Note: We do not recommend fixing directly to plaster walls. Attach at wall stud (wooden joist) locations only.

3. **For brick or concrete installation**, insert 4 x plastic plugs into hole ensuring they are flush with the surface. Secure side arms to wall with the screws provided. **Do not fully tighten at this stage.**

For timber walls installation, secure side arms to wall with screws provided (discard plastic plugs).

Do not fully tighten at this stage.

For fixing to alternative wall materials, consult your local hardware specialist.

4. Spread side arms apart and slide front bar into position. Ensure side arms are inserted fully into front bar. (See figure 2). Fully tighten all wall mounting screws.

5. Start threading line from inner most hole (see figure 1) and continue up to last hole position. Thread line through line tensioner, pull tight, loop 2-3 times around tensioner and lock into place (see figure 3). Trim excess line leaving approximately 50mm.

Figure 2.

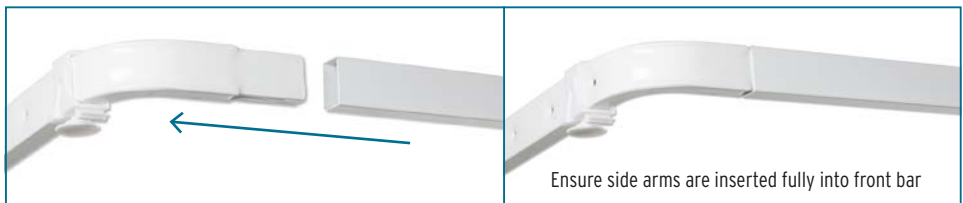
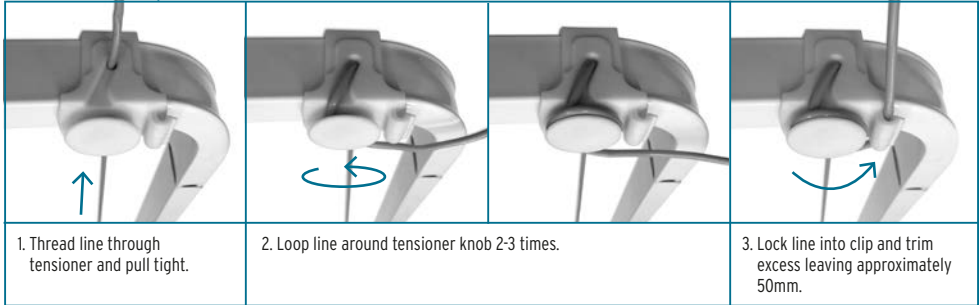
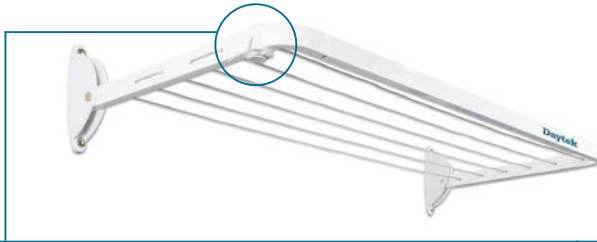

Figure 3.



OPERATING YOUR CLOTHESLINE

This clothesline uses a Lift & Lock mechanism. To raise the clothesline, hold the FRONT BAR with hands spaced evenly. Lift above the horizontal (1) and push towards the wall (2). Release your grip and the clothesline will be locked into place.

To fold down the clothesline, lift the FRONT BAR and pull outwards. This will unlock the clothesline and allow you to lower it.

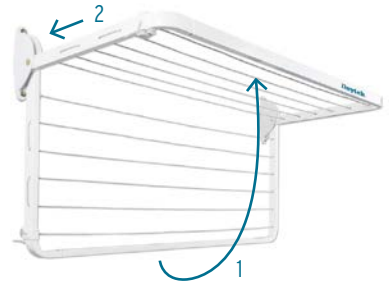

15 YEAR PRODUCT WARRANTY

Our goods come with guarantees that cannot be excluded under the Australian Consumer Law. You are entitled to a replacement or refund for a major failure and for compensation for any loss or damage. You are also entitled to have the goods repaired or replaced if the goods fail to be acceptable quality and the failure does not amount to a major failure.

If any part of this clothesline fails to operate correctly due to faulty workmanship or defective material Daytek

Australia will repair or replace free of cost within 15 years from the date of purchase. (Receipt of purchase required). The PVC line cord is covered by a 2 year warranty from the date of purchase. Any evidence of misuse or incorrect adjustment will void the warranty. To claim a product warranty, please contact Daytek Australia directly. You must bear the cost of claiming the warranty. This warranty is in addition to other rights and remedies of the customer under law.

For further warranty information please visit www.daytek.com.au

Manufactured/Supplied by Daytek Australia Pty. Ltd.

77-81 Gower Street, Preston

Victoria 3072 Australia

T +61 3 9470 1755

F +61 3 9470 5381

E enquiry@daytek.com.au

daytek.com.au



Daytek[®]
Design for Today